

SCREWLESS TYPE TERMINAL BLOCK

UL E133988(R)

ETBF60 SERIES

SCREWLESS TYPE

PRODUCTS PITCH=6.9mm
P.C.B. PITCH=7.5mm

FEATURES

- Easy to assemble for any number of positions
- End stackable without any loss of P.C.B. space
- UL 94V-0 grade fire retardant engineering plastic used for the housing
- Be capable of clamping a wide range of wire diameters
- Screwless design can reduce time for connecting wire
- RoHS Compliant
- Halogen free series available

SPECIFICATIONS

- Products pitch 6.9mm
- P.C.B. pitch 7.5mm
- Wire range Ø0.8~Ø2.0mm (Solid)
- No. of pole per block 2P
- Rating 10 Amp, 300 VAC
- Housing PBT
- Terminals Tin plated over Copper Alloy
- Springs Stainless Steel
- Push button PBT
- Operating temperature -30°C~+110°C
(includes temperature rise limit)
- Stripping length 12mm
- UL Approval 300V, 10A, 12~20 AWG
- TUV Approval 300V, 10A, 12~20 AWG



PART NUMBERING SYSTEM

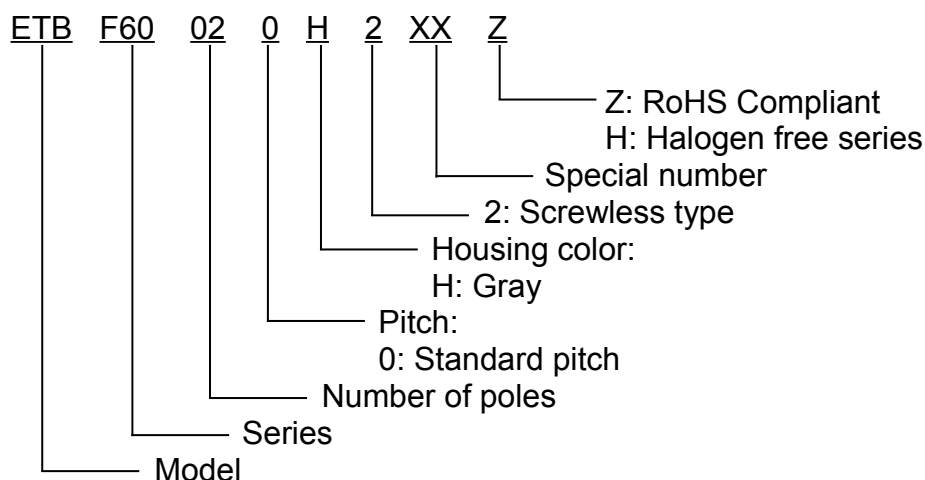

DRAWING

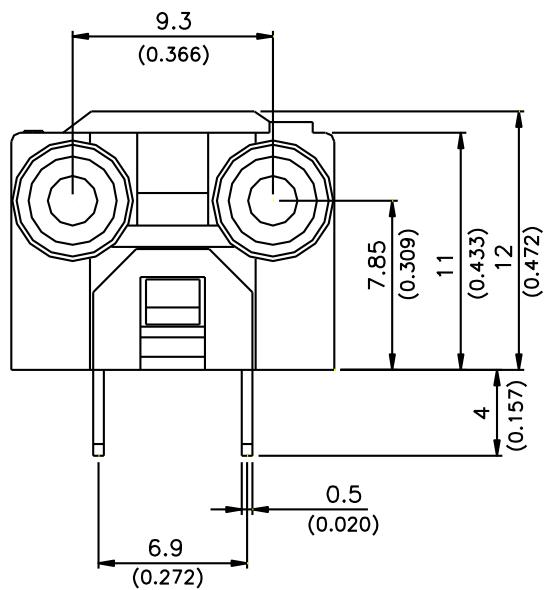
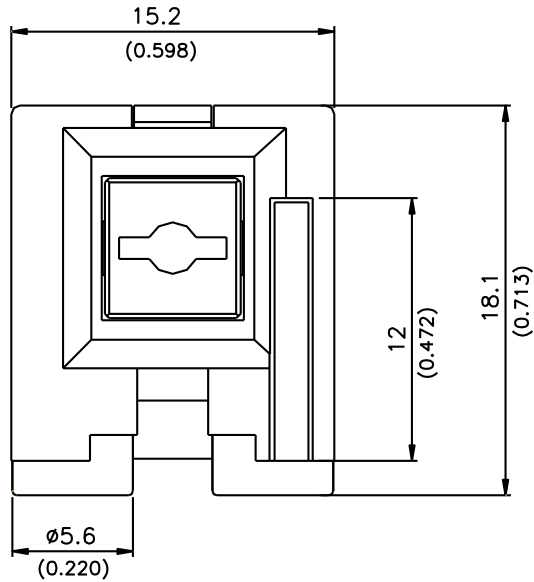

P.C.B LAYOUT(reference)

