



SUMMARY

The Micro Motor is Converted to High Output Torque via a Gear Box
Customizable Gearbox Deceleration Ratio

USES

- LED Light Control
- Driving Recorder & Navigation
- Micro Projector
- Automatic Inspection Equipment
- Medical Equipment

➤ DIMENSIONS :

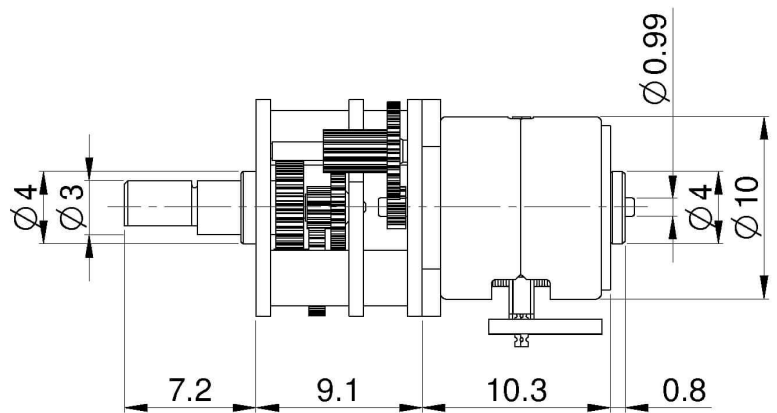
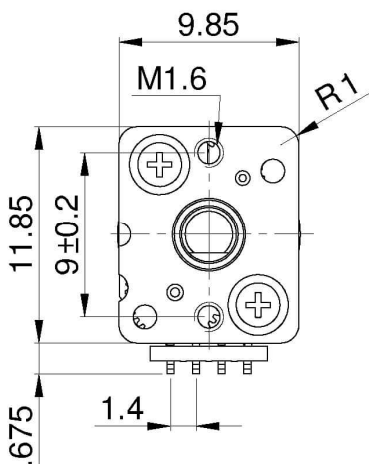



NEOCENE

2A1013 | SPECIFICATION

Item	2A1013
Standard voltage	12V
Standard Current	140 mA/Phase
Number of phase	4 Phase
Step angles	18° / Step(Output shaft 0.305° / Step)
Transmission ratio	1:59 (customization)
Excitation	1-4 Bipolar
Pull-out torque	280 g-cm or more / 2640 pps
Holding torque	400 g-cm or more
Resistance per phase	50 Ω
Max pull-out pulse rate	14000 pps or more
Max pull-in pulse rate	4000 pps or more

➤ CHARACTERISTICS :

12V

