



REED SENSOR ELS 5 SERIES

■ FEATURES

- Does not require power for operation.
- Cylindrical and fastening screw is options.
- Available in close loop or open loop.
- Reed sensors or magnet only are available separately.

■ APPLICATIONS

- Security system
- Control equipment
- Automotive device

■ SPECIFICATIONS

1.ELECTRICAL CHARACTERISTICS

Contact form	A or B
Contact rating	10W
Maximum switching voltage	100Vdc
Maximum switching current	0.5A
Maximum carry current	1.0A
Contact resistance	200mΩ max.
Breakdown voltage	200Vdc min.
Insulation resistance	10 ⁸ Ω min.

2.OPERATING CHARACTERISTICS

Shock resistance	30G(11ms)
Vibration resistance	20G (10~55Hz)
Temperature range	-20~+60°C
Life expectancy (30Vdc-0.1A, Resistive load)	1x10 ⁷

■ PART NUMBER SYSTEM

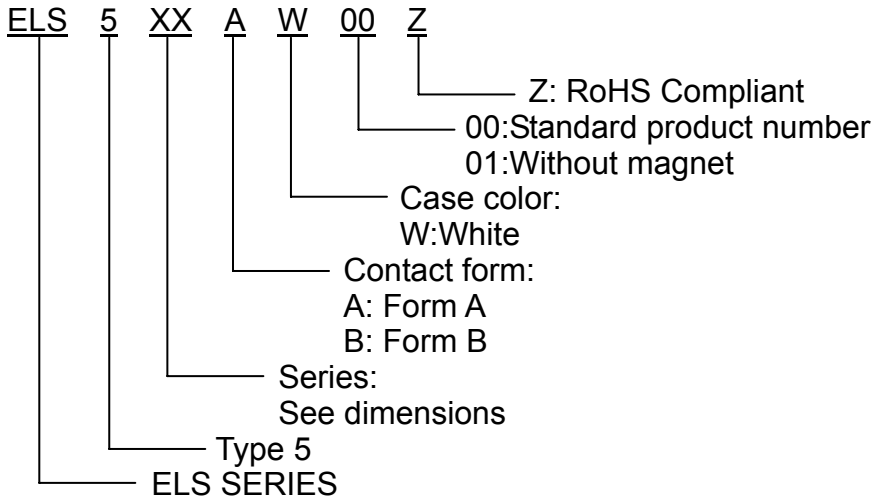

■ DIMENSIONS UNIT:mm

◆ ELS511AW00Z (Contact form: A)

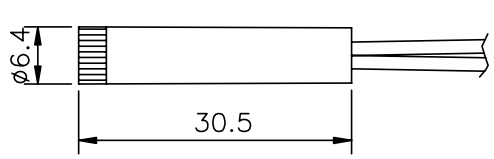
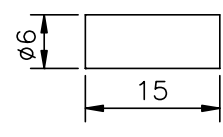
Body	Magnet (ELS511Z)
	

◆ ELS531AW00Z (Contact form: A / B)

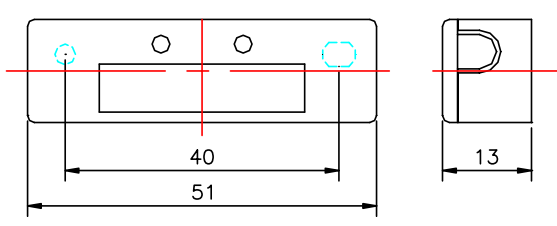
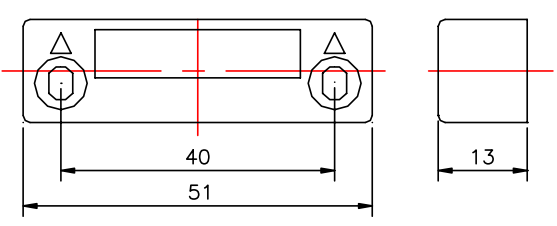
Body	Magnet (ELS531Z)
	

◆ ELS541AW00Z (Contact form: A / B)

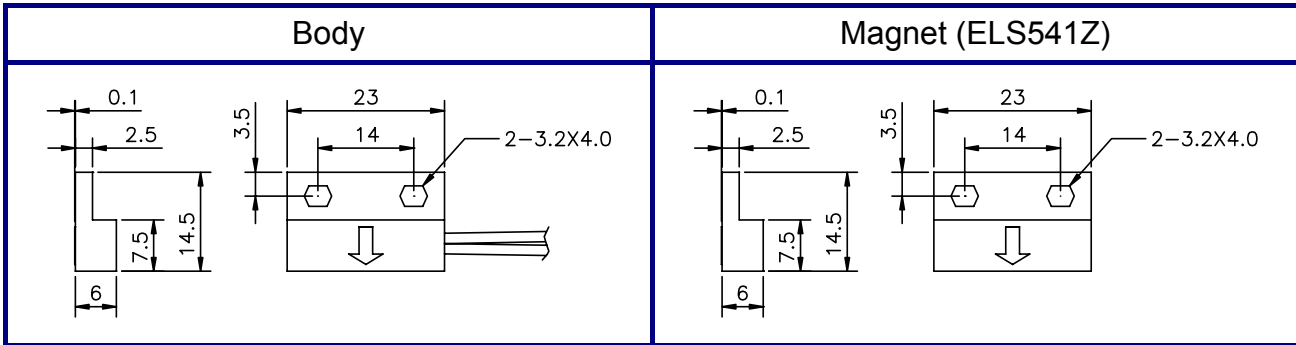

◆ ELS542AW00Z (Contact form: A)

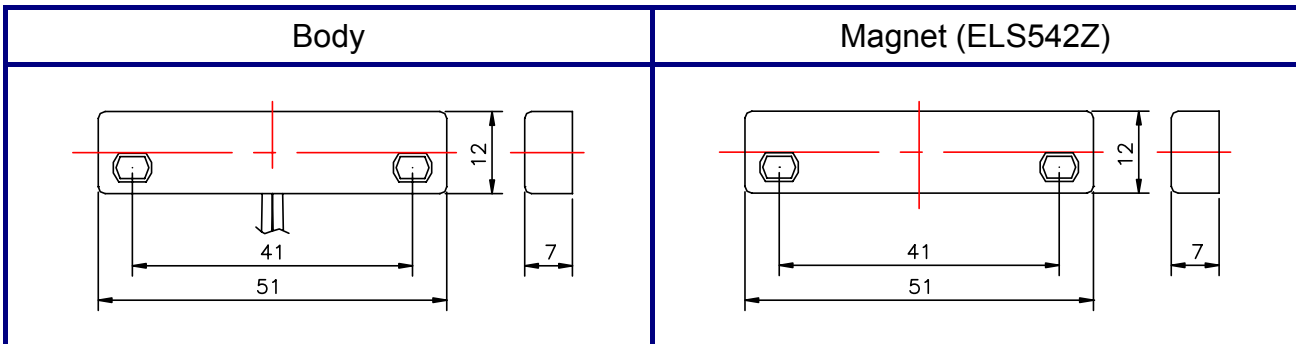

◆ ELS543AW00Z (Contact form: A)

